

# Replacing Batteries

June 2011

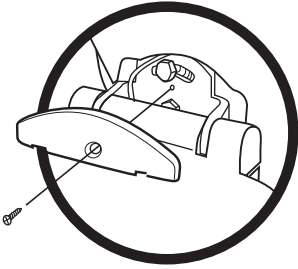

The following procedure must be **STRICTLY** adhered to, to avoid damage.  
**DAMAGE CAUSED BY THE INDIVIDUAL IS AT THEIR OWN RISK.**



**1.** Remove the footrest hinge cover by removing the screw.

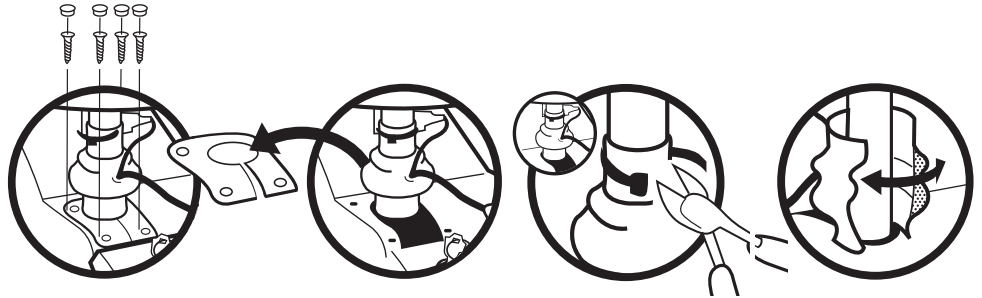

**2.** Undo screws on the bezel around the seat post and remove. Cut and undo the cable tie around the gaitor. Remove the gaitor.

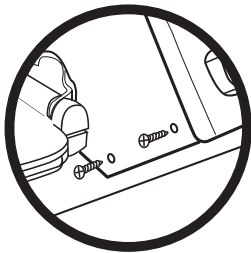

**3.** To remove the main carriage cover, remove the 2 screws that are located along the front bottom edge.

**4.** Tilt the footplate and gradually remove the cover on an angle. It may be necessary to loosen the footplate adjusting bolt.

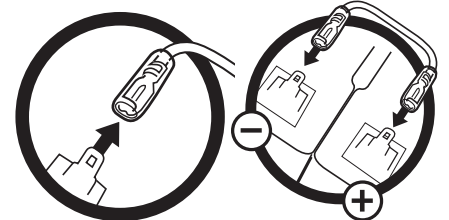
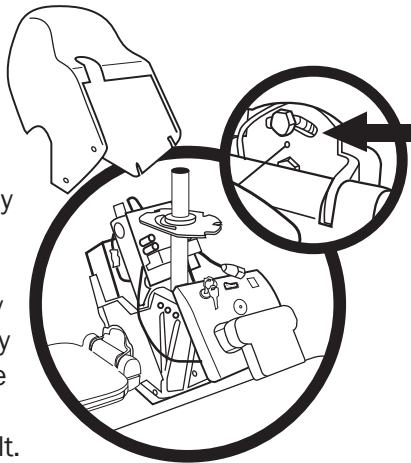

**5.** Remove the Negative first and then the Positive terminal connectors from the batteries. Remove the joining link wire connector between the two batteries.

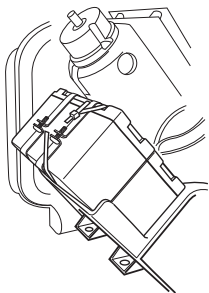

**6.** Cut the cable tie that holds the batteries together.

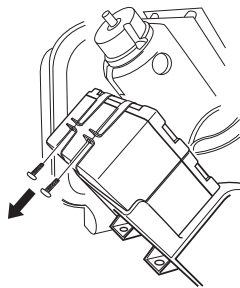

**7.** Remove the two screws from the metal straps.

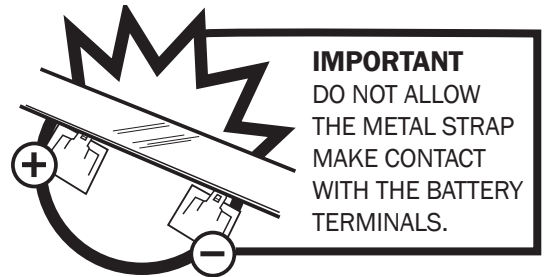

**IMPORTANT**  
DO NOT ALLOW THE METAL STRAP MAKE CONTACT WITH THE BATTERY TERMINALS.

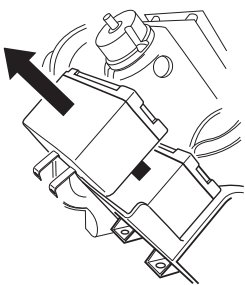

**8.** Slide the batteries out from the carriage chassis and replace with the new ones.

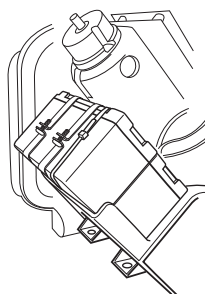

**9.** Attach a new tie clip around the batteries.

Screw the metal straps together.

Attach the link wire first, Positive and then the Negative terminals back on to the batteries.

**10.** Place the carriage cover back onto the chassis and attach with the two screws. If necessary tighten the footplate adjusting bolt. Attach the footrest hinge cover.

Screw the bezel around the seat post and attach the gaitor using a new cable tie.